

This drawing is the copyright of HJ.CONCEPTS LTD and may not be copied, altered or reproduced in any way without their written authority. © HJ Concepts Limited 2020

Do not scale this drawing. Use written dimensions only. All dimensions shall be checked on site prior to commencement of work.

IF IN DOUBT ASK

DO NOT SCALE: This note may be omitted for **PLANNING PURPOSES ONLY**. Original documents only may be relied upon. Inaccuracies may occur due to printing, scanning and other forms of copying.

This drawing has been produced for **Mr J Newtham & Mrs A Johnson** for the **Hillside View, Horsebridge Road, King Sombourne, SO20 6PT** and is submitted as part of a **Householder Planning Application** and is not intended for use by any other person or for any other purpose.

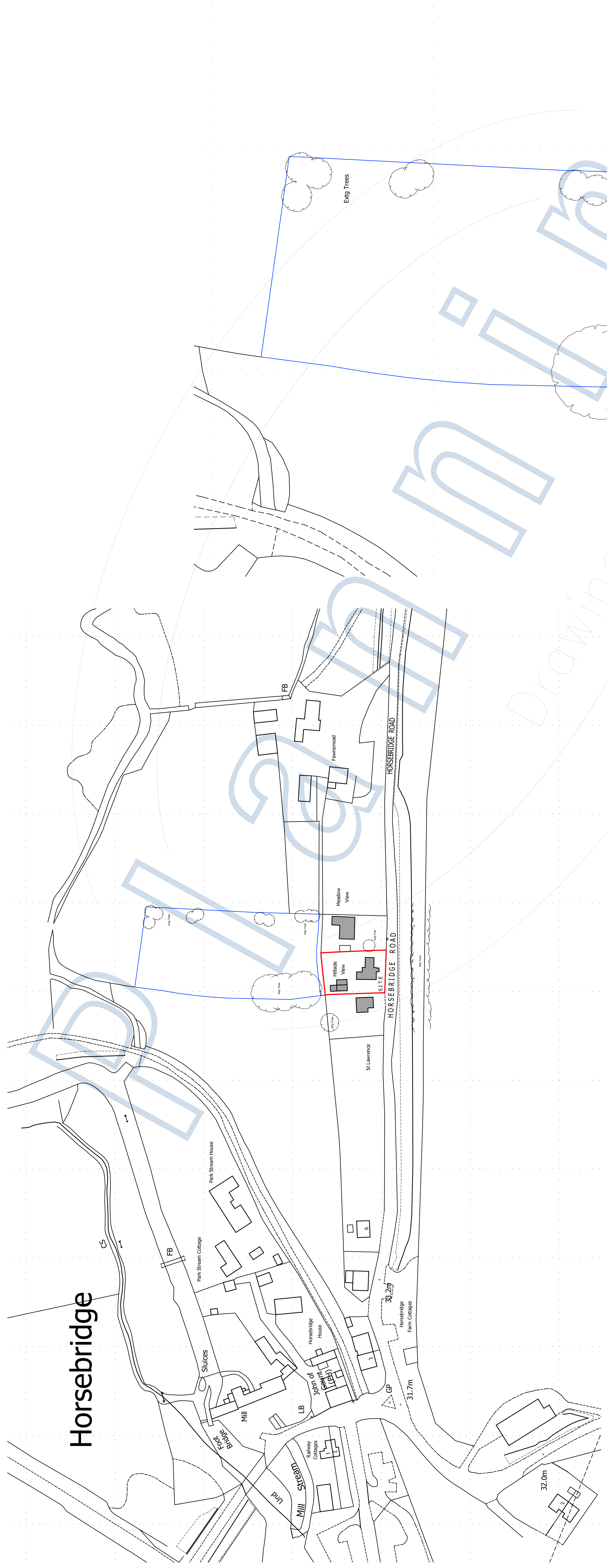

Location Plan 1:1250

Crown Copyright 2020. All rights reserved. Licence number 10002432

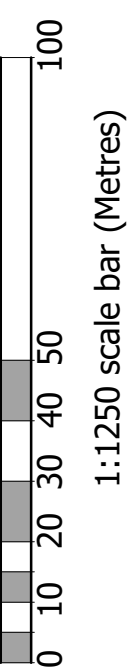

1:1250 scale bar (Metres)

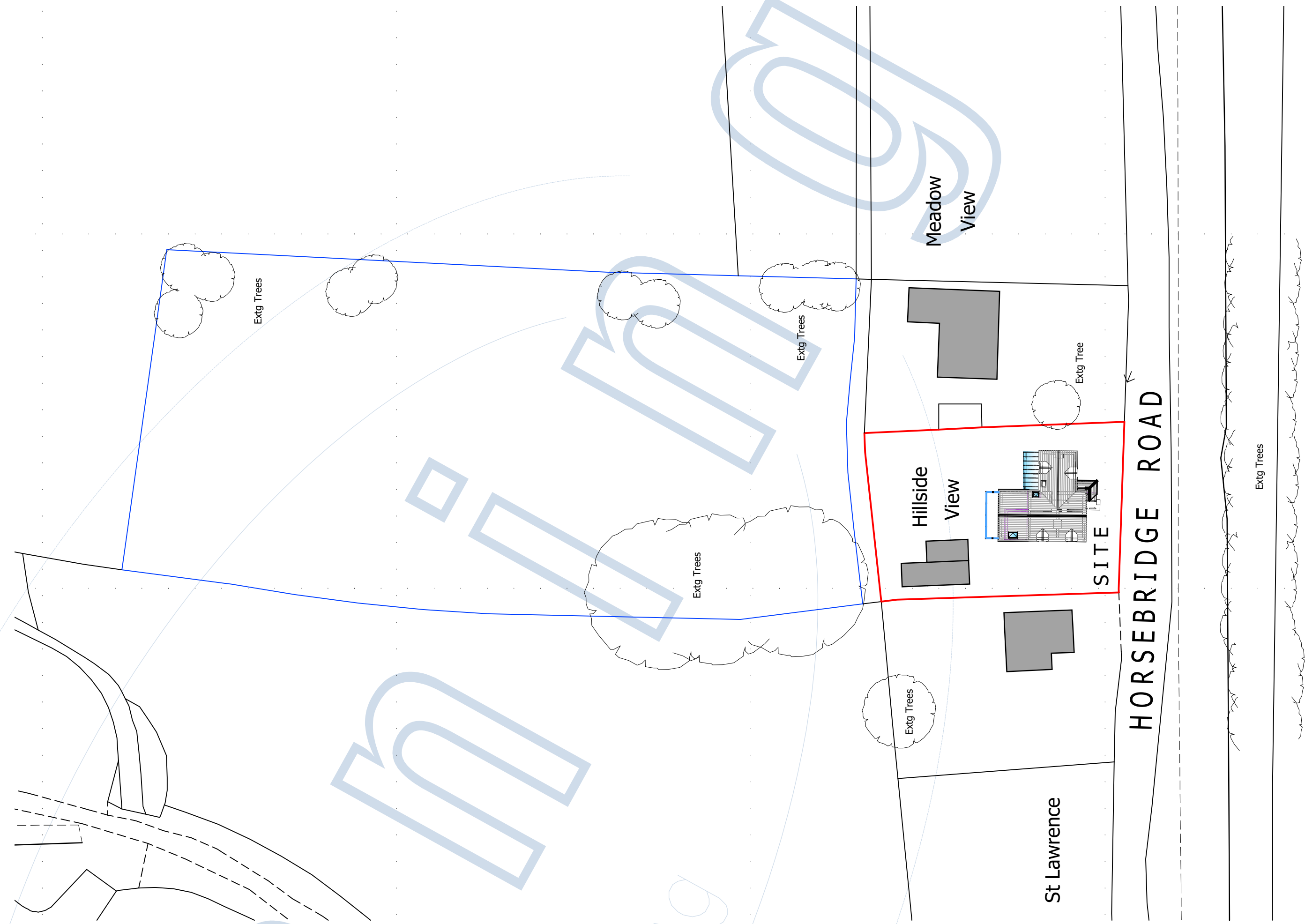
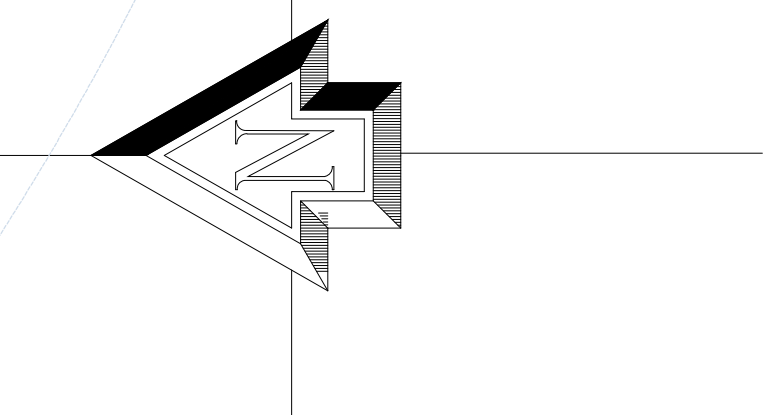

Block Plan 1:500

Crown Copyright 2020. All rights reserved. Licence number 10002432

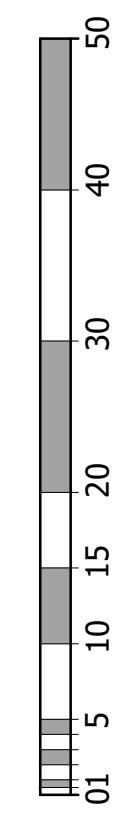

1:500 scale bar (Metres)

REV	DATE	DESCRIPTION	BY
-	04.12.20	Issued for Householder Planning Application	

HJ CONCEPTS LTD
 Suite A Second Floor
 Trinity Court 2-4 West Street
 Fareham, Hampshire. PO16 0BH
 Telephone: 01329 288684. Email: office@hjconcepts.co.uk

Mr J Newtham & Mrs A Johnson
 Hillside View, Horsebridge Road
 King Sombourne, Hampshire. SO20 6PT

Proposed Location & Block Plans

ISSUED BY	DATE	SCALE
PH	Nov. 20	1:1250, 500
PROJECT AND DRAWING NO.		
19-1322 — PL 01		