

Friars Orchard, West Dean

This drawing is copyright and is not to be reproduced. The contractor will be held responsible for the accuracy of works involving the setting out and checking of all dimensions on the drawing and on site. Dimensions must not be scaled from this drawing.

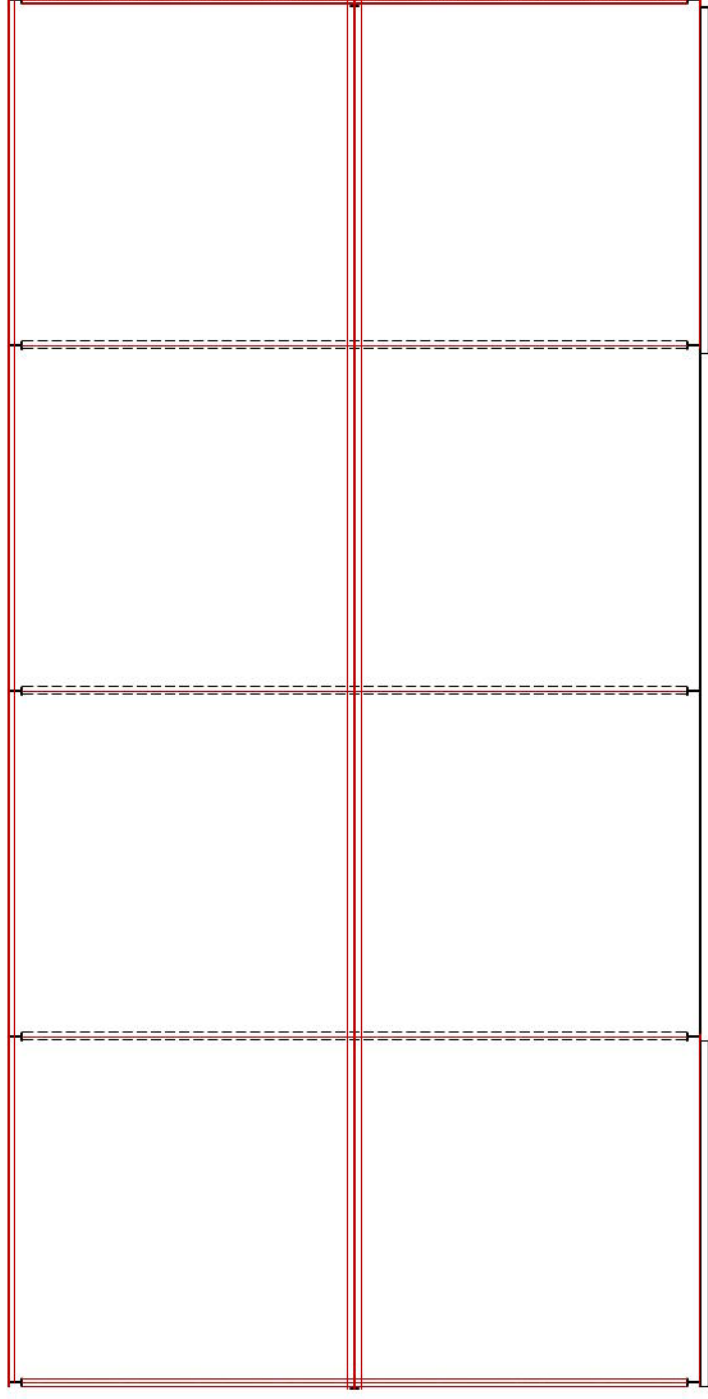

Existing roof plan 1:100

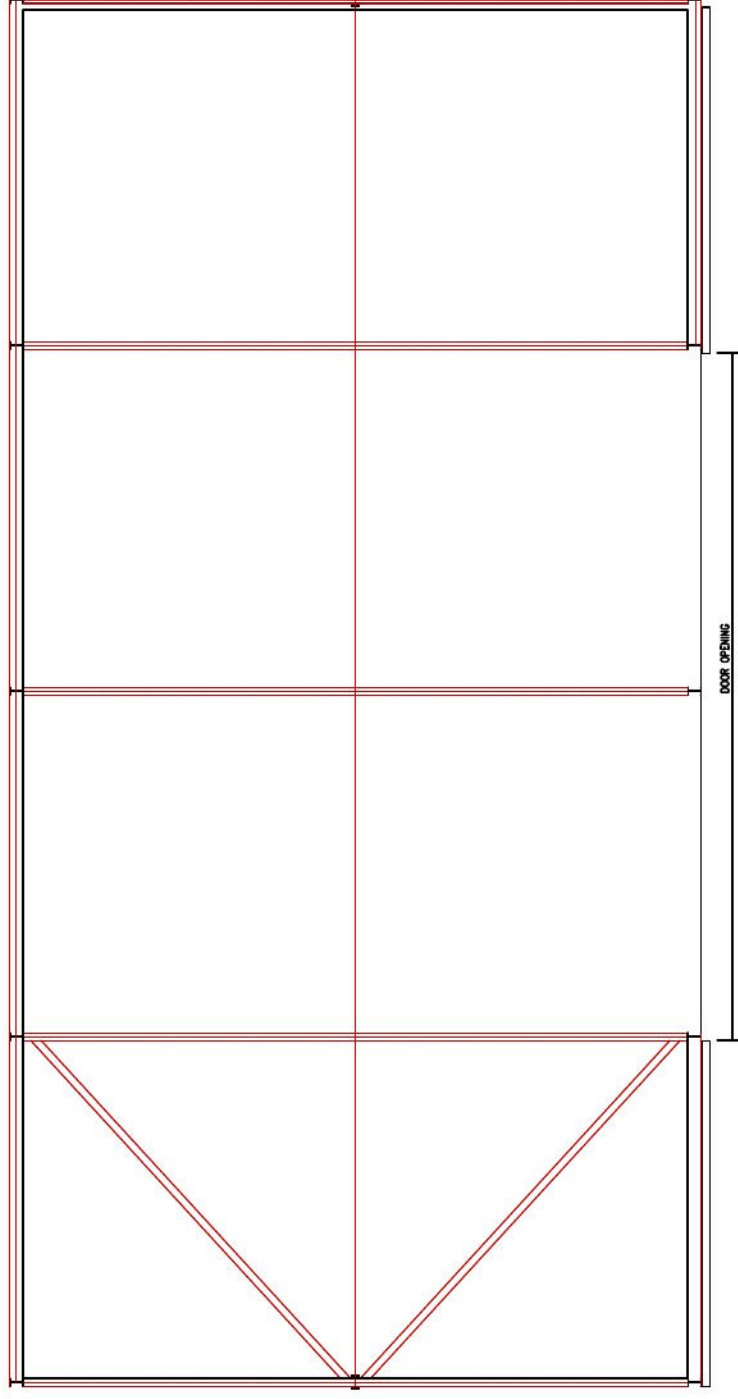

Existing floor plan 1:100

Existing barn area = 159sqm

Rev c - 12/02/2021 - planning application, ridge height raised, windows and rooflights adjusted



Rev -

Client: Simon & Edward Parsons	Planning	
Project: Planning application for barn at Friars Orchard, Rectory Hill, West Dean, Salisbury SP5 1JL	Drawing No: 0202-02-02-002a	Revision:
Title: existing plan	Drawn: rjb	Scale: 1:100 @ a3
	Check:	First Issue: AUG 2020

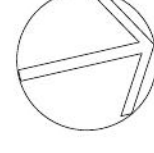

bircharchitects
Lambourne, Grove Lane, Redlynch, Salisbury, Wiltshire, SP5 2NR
T: +44 (0)1725 510407
e: info@bircharchitects.co.uk