

0 0.5 1.0 1.5 m

Scale 1:50 @ A3

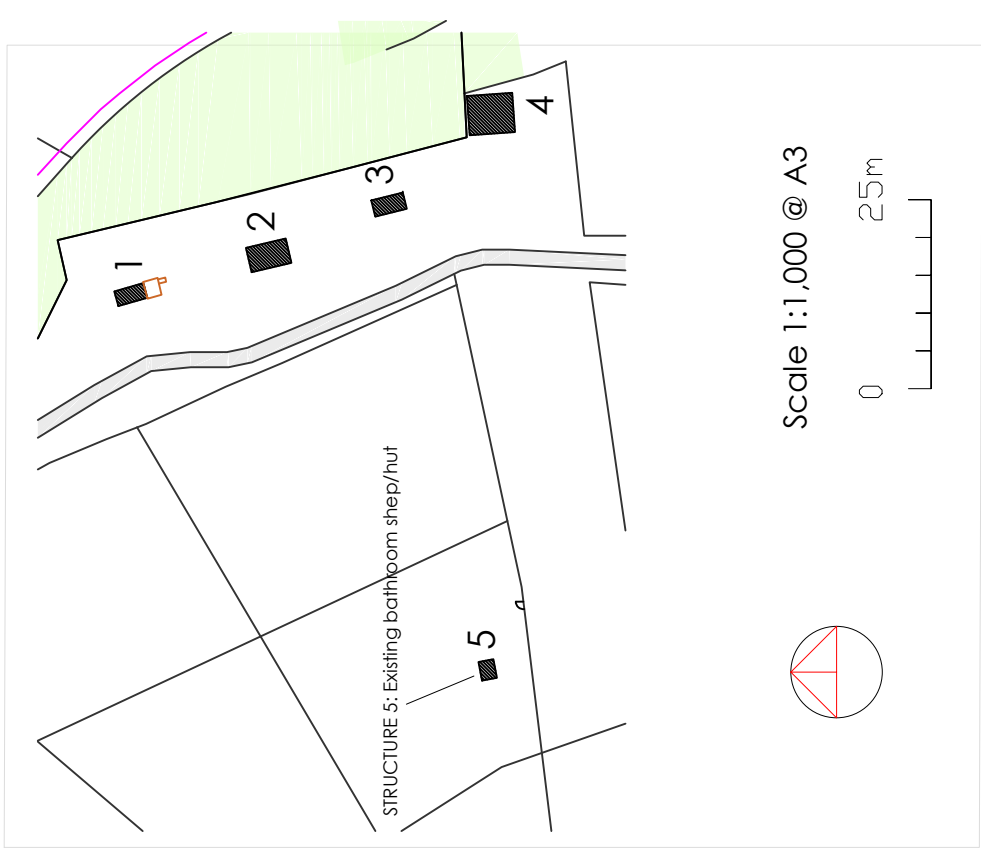

The bathroom Shepherds' Hut was placed on this site before Spring 2019 - see Statutory Declaration.
See photographs that show the siting with a dense tree belt backdrop alongside the former golf course fairway.
It is fixed on the plot by the electricity cables and fresh/foul water. It is connected to a sealed septic tank that is pumped out by a tanker that accesses the site from the track to the west.
It has x4 metal wheels.

DATE	March 2023
CLIENT	The Owners
ADDRESS	Hilltop Farm
TITLE	STRUCTURE 5: Existing bathroom shep/hut
DRAWING No	BEN 4005
REV	A
1: 1,000 and 1:50 @ A3	
11/04/23 RG / PT	